



the pointe  
at wildflower station



PRELIMINARY







## the pointe at wildflower station

Located in Antioch, California, The Pointe at Wildflower Station features panoramic views of Mt. Diablo. Just a short drive to Antioch BART, Dunes National Wildlife Refuge, the San Joaquin River Delta, The Crossing Shopping Center, and more - you'll never run out of things to do in the area.

Within the community, you'll find 22 single-family homes and a community green with a bocce court and picnic tables. The homes are beautifully designed with a nod to craftsman, spanish revival and traditional details. These 22 homes range from 2,187 - 2,303 Sq. Ft. with 4 bedrooms and 3 baths, plus all the amenities you would expect from a DeNova Home.

With easy access to highways, public transportation, nearby attractions, and a beautiful community, it's easy to see why The Pointe at Wildflower Station is so appealing!





## RESIDENCE 1

Approx. 2,187 sq. ft.  
4 Bedrooms | 3 Baths  
2-Car Garage



# RESIDENCE 1

Approx. 2,187 sq. ft. | 4 Bedrooms | 3 Baths | 2-Car Garage

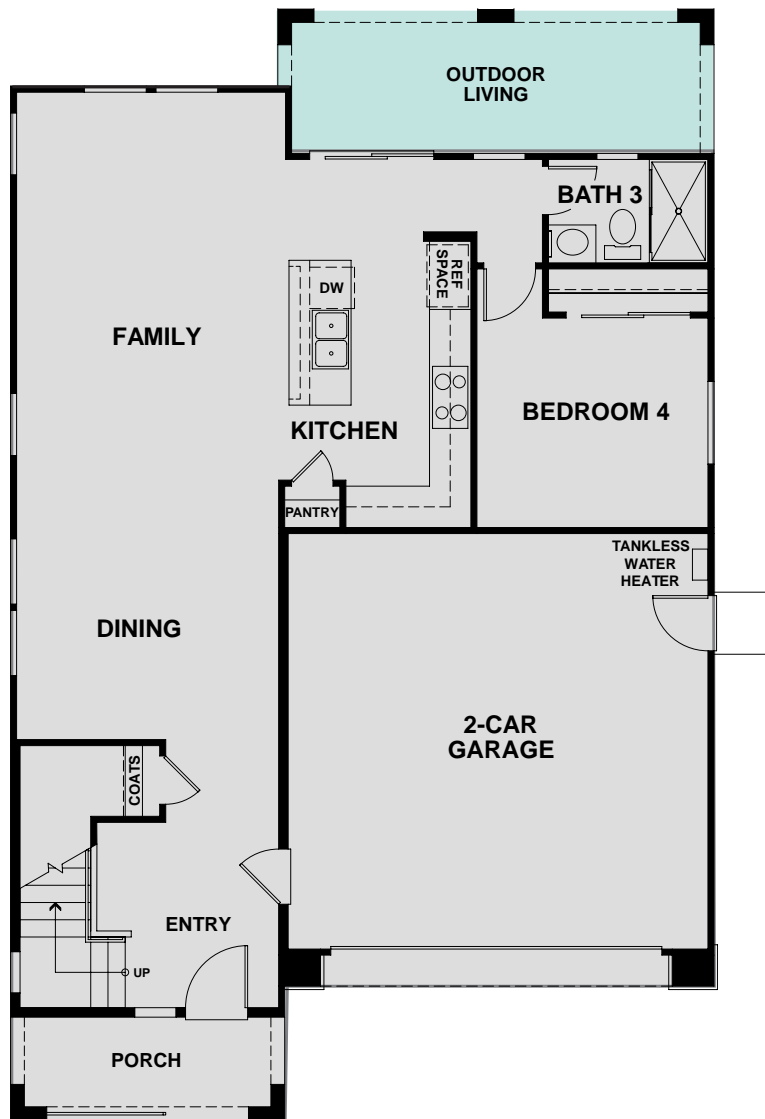

**FIRST FLOOR**



**SECOND FLOOR**





## RESIDENCE 2

Approx. 2,303 sq. ft.  
4 Bedrooms | 3 Baths  
Loft | 2-Car Garage



## RESIDENCE 2

Approx. 2,303 sq. ft. | 4 Bedrooms | 3 Baths | Loft | 2-Car Garage



FIRST FLOOR

SECOND FLOOR



## INCLUDED

### KITCHEN

- Stainless GE appliance package with 30" range, microwave and dishwasher.
- Slab granite countertops with 6" splash with full splash behind range in three color choices.
- Leland Delta pullout faucet.
- Amerisink single basin stainless steel undermount sink.
- Birch cabinets in six color choices.

### BATHS

- Birch cabinets in six color choices.
- White cultured marble countertops with 4" splash.
- Integral rectangle sink.
- Elongated toilets in all bathrooms.

### INTERIORS

- Shaw luxury vinyl plank flooring at entry, dining, family room, kitchen, and bath 3.
- Hand laid Emser 12" x 12" ceramic tile at master bath, bath 2, and laundry.
- Shaw Fastball carpet in all bedrooms.
- 3¼" base molding with eased edge.
- Cat5 phone wiring to bedrooms and kitchen.
- RG6 cable wiring to family room and bedrooms.
- Paint grade handrail.
- Semi-insulated garage doors.
- Ceiling lights in all bedrooms.

### SMART HOME FEATURES

- LED recessed can lights in select locations.
- Interior low-VOC paint.
- Tankless water heater.
- Dual zoned air conditioning.
- Smart Hub to control smart thermostat, garage door, smart lock with keypad at front door and camera doorbell.

### LAUNDRY

- Birch cabinets in six color choices.
- White cultured marble countertops.
- Plumbed for washer and gas dryer.

## AVAILABLE OPTIONS

### APPLIANCES

- Upgrade to GE option packages.
- GE refrigerator options.
- GE washer and dryer options.

### CABINETRY

- Rich finish door style and hardware selections.
- Built-in cabinetry.

### COUNTERTOPS

- Selections of natural granite slab or quartz countertops at kitchen with decorative edge choices.
- Natural stone or quartz available at bath and laundry.

### FINISH TRIM

- Upgraded 5¼" base board.
- Interior two-tone paint upgraded colors.
- Closet organizers.
- Framed mirror sections at all bathrooms.

### PLUMBING

- Selection of kitchen faucets.
- Upgraded Amerisink apron front stainless steel sink.
- Selections of plumbing fixture packages.

### ELECTRICAL

- Security, audio and home automation systems.
- Upgraded lighting packages available.
- Ceiling fan.
- Solar.





the pointe  
at wildflower station



RESIDENCE 1



RESIDENCE 2



SITE MAP







*Building a Better Community®*

For 30 years, DeNova Homes has earned a reputation as one of the most respected homebuilders in California. Our approach is simple—as a private, family-owned builder, we address each community individually, incorporate the unique characteristics of the surrounding area and commit to build only the very best. These guiding principles have been recognized numerous times by the Building Industry Association through various awards, including the prestigious Builder of the Year award. Perhaps most rewarding of all though are the hundreds of satisfied homeowners who have confirmed DeNova Homes' standard of quality, lifestyle, and value.

While we focus on innovative design and superior craftsmanship, our primary commitment is to the lifestyle our homeowners enjoy when they move into a DeNova home. Building community is what we do, whether it is creating the ultimate environment for your dream lifestyle, building homeless shelters with HomeAid Northern California, or supporting the American Red Cross, Volunteers of America, the American Cancer Society, and many other local organizations. DeNova Homes is there for the neighborhoods in which we build. It is our defining goal. It is what makes us proud. It's what creates *Home*.





the pointe  
at wildflower station



PRELIMINARY

**THE POINTE AT WILDFLOWER STATION**

Wildflower Drive & Hillcrest Ave. • Antioch • CA • 94531  
(925) 233-3552 • [ThePointe@DeNovaHomes.com](mailto:ThePointe@DeNovaHomes.com) • [DeNovaHomes.com](http://DeNovaHomes.com)

